

REV	DESCRIPTION	NAME	DATE
-----	-------------	------	------

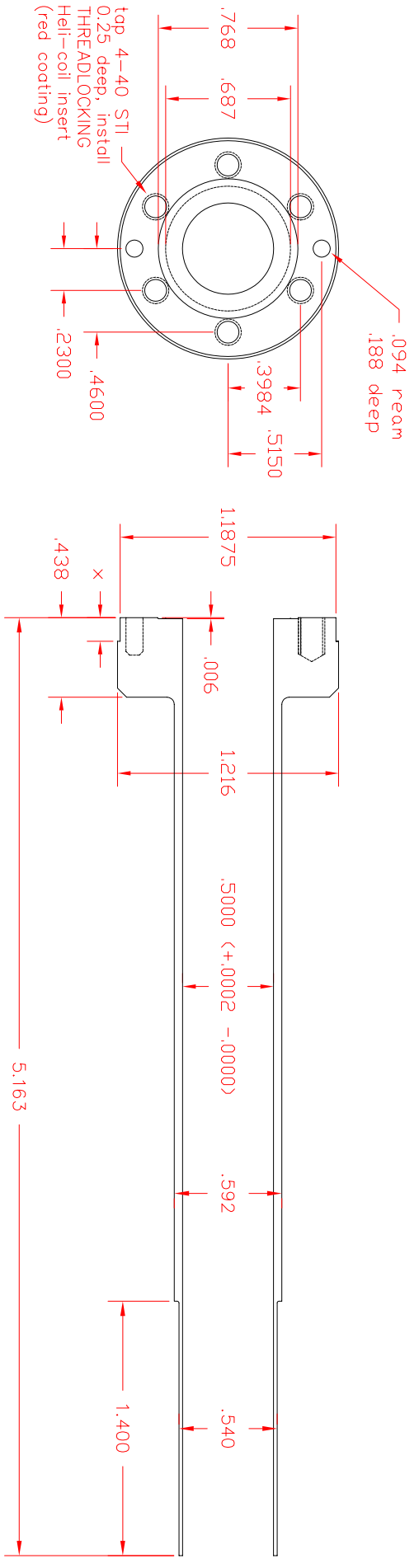

- notes:
1. bore cylinder to 0.4990 (-0.0000 +0.0005), then hone to 0.5000 diam
 2. at 0.687 diam, leave narrow raised lip 0.003 high

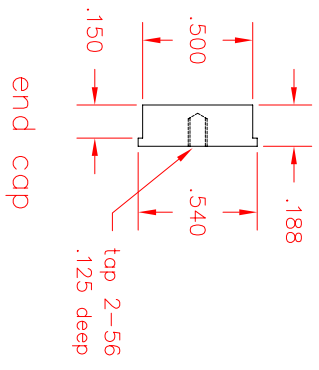

MATERIAL		UNLESS OTHERWISE SPECIFIED TOLERANCES ARE:		RADIO ASTRONOMY LABORATORY	
304 SS		X	#	FRAC.	#
FINISH		.XX	#	ANGLE	#
		.XXX	#	FINISH	#
DRWN	NAME	DATE	UNIVERSITY OF CALIFORNIA - BERKELEY		
APPR		12Jun95	BIMA cryocooler		
WEIGHT	SCALE	SIZE	3rd stage cylinder		
		C	CODE	DWG NO	SHEET
				28-024	B
					REV